

# TASK 1 - EARTHWORKS

Technology of constructions I

# Lecture

---

- Earth work processes;
- Laying-out of the building;
- Definition of the foundation pit, trenches, wells;
- Manners and procedures of their execution;
- Applicable mechanization.

# Exercise

- Construction localization and demarcation;
- Procedure of earthworks execution, excavation;
- Graphical representation of the earthwork processes;
- Machinery selection for the earthworks for the selected construction, some machinery work techniques, the scheme of machinery movement on the construction site.

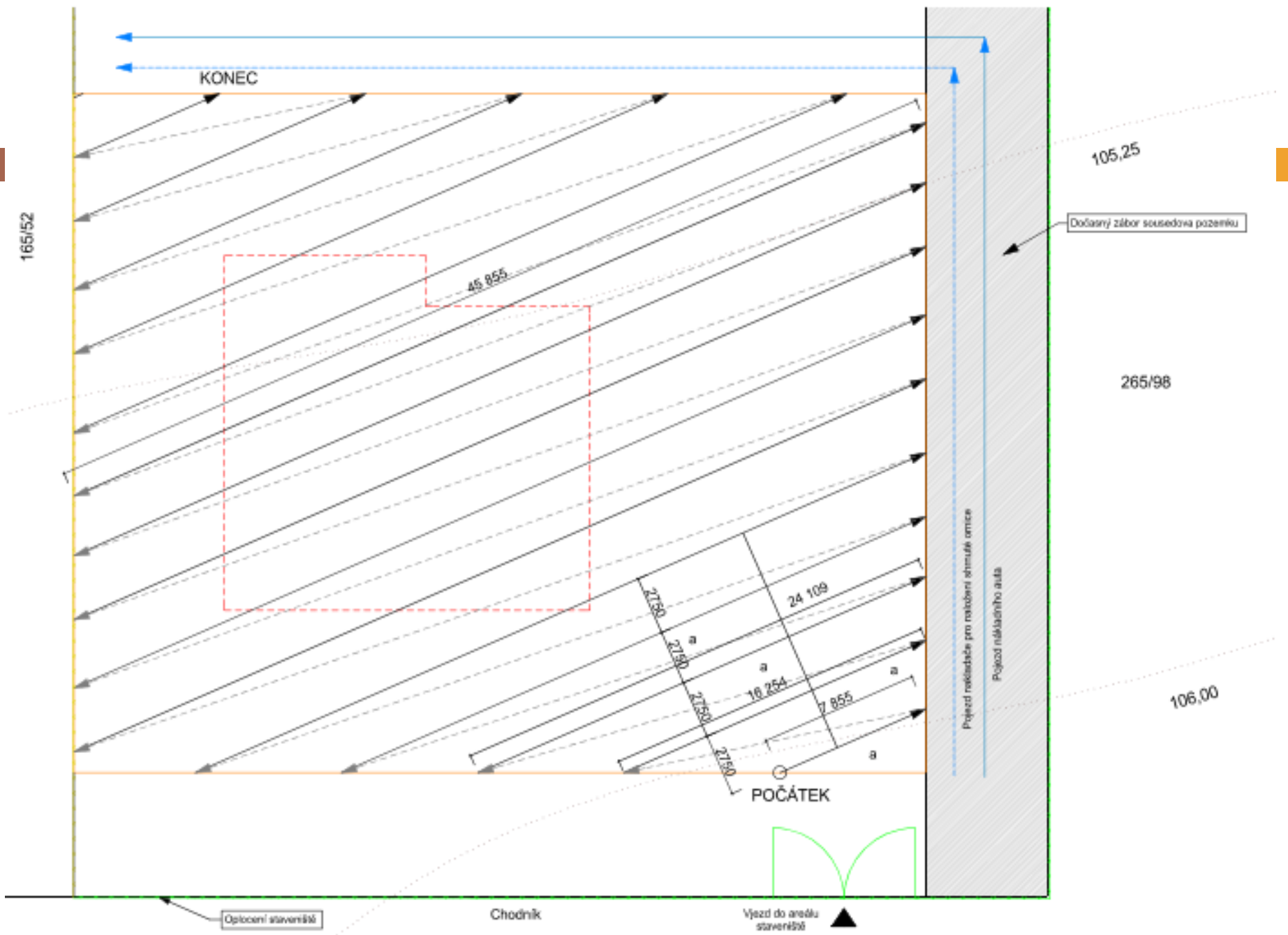

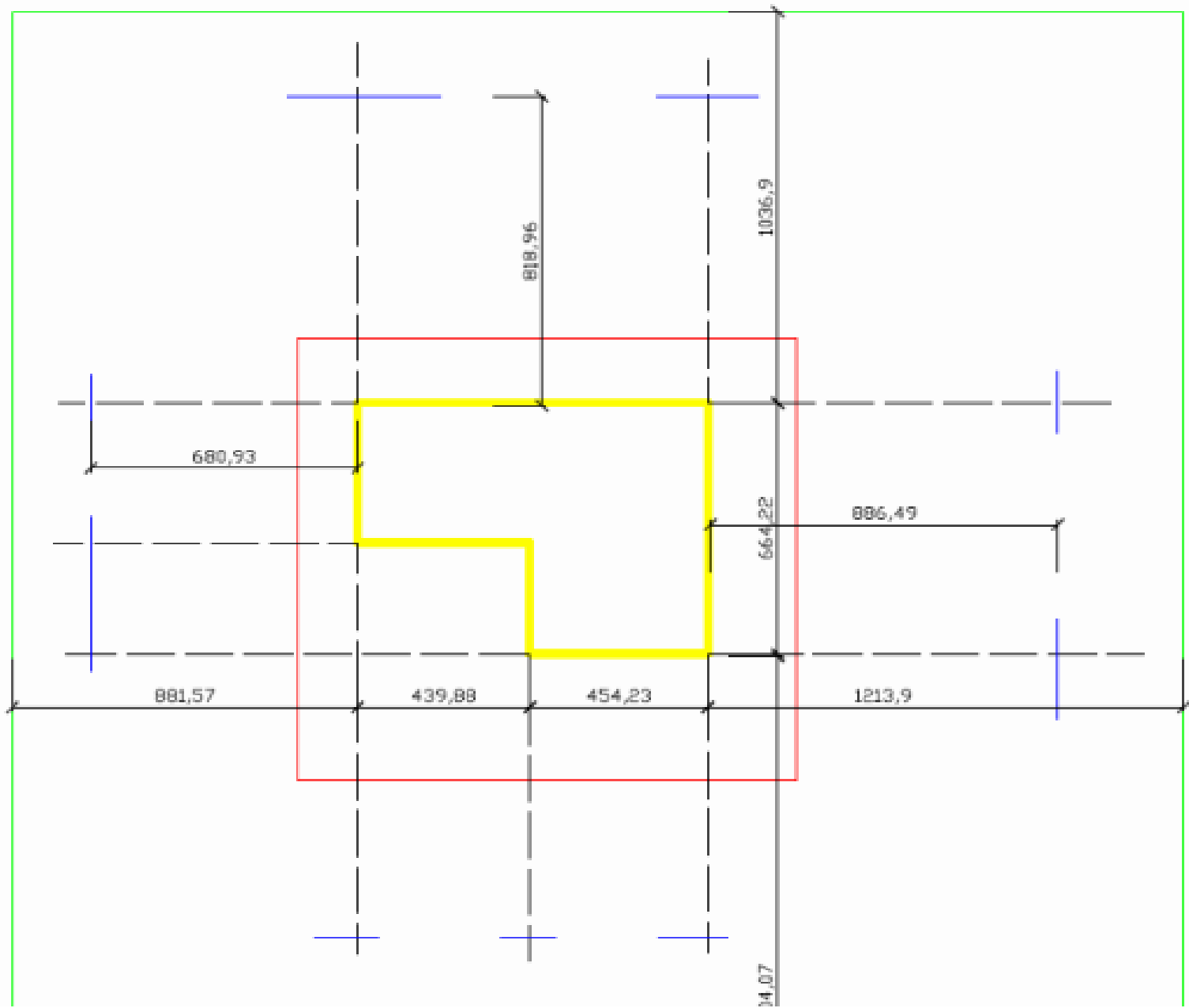

# Task 1

- **NAIL FOR STABILIZATION OF THE LOCATION OF THE PIT EDGE**

- **TIMBER BOARD**  
**WOODEN STAKE**

**THE ORIGINAL SOIL**

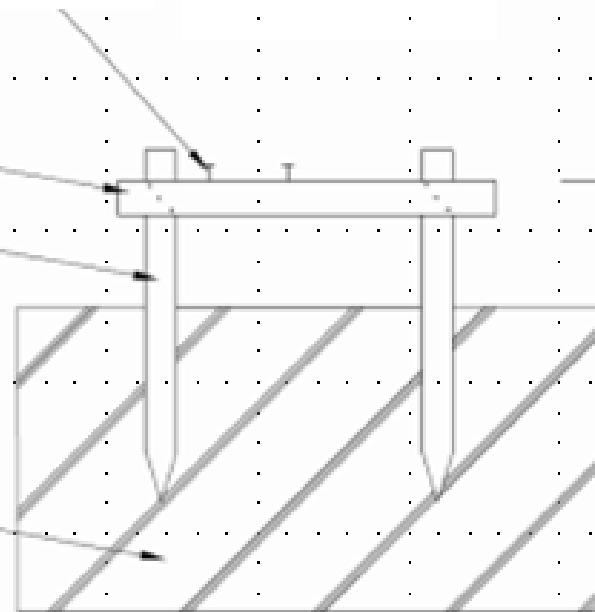

0,000 =  
LEVEL OF 1.NP

# SCHEMA POJEZDU RYPADLA-NAKLADAČE WB93S-5

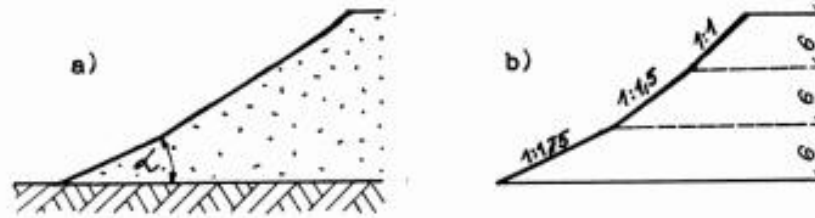

*Provedení jednotného svahování a svahování pro různé vrstvy zeminy v průběhu výšky jámy*

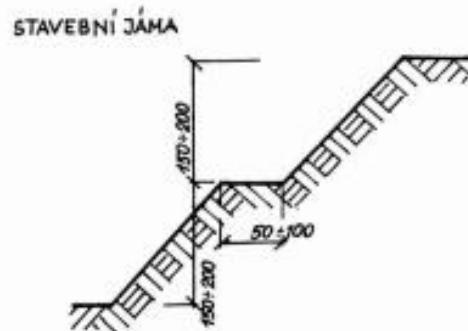

Obr.4.3 Úprava svahu hlubší stavební jámy

T

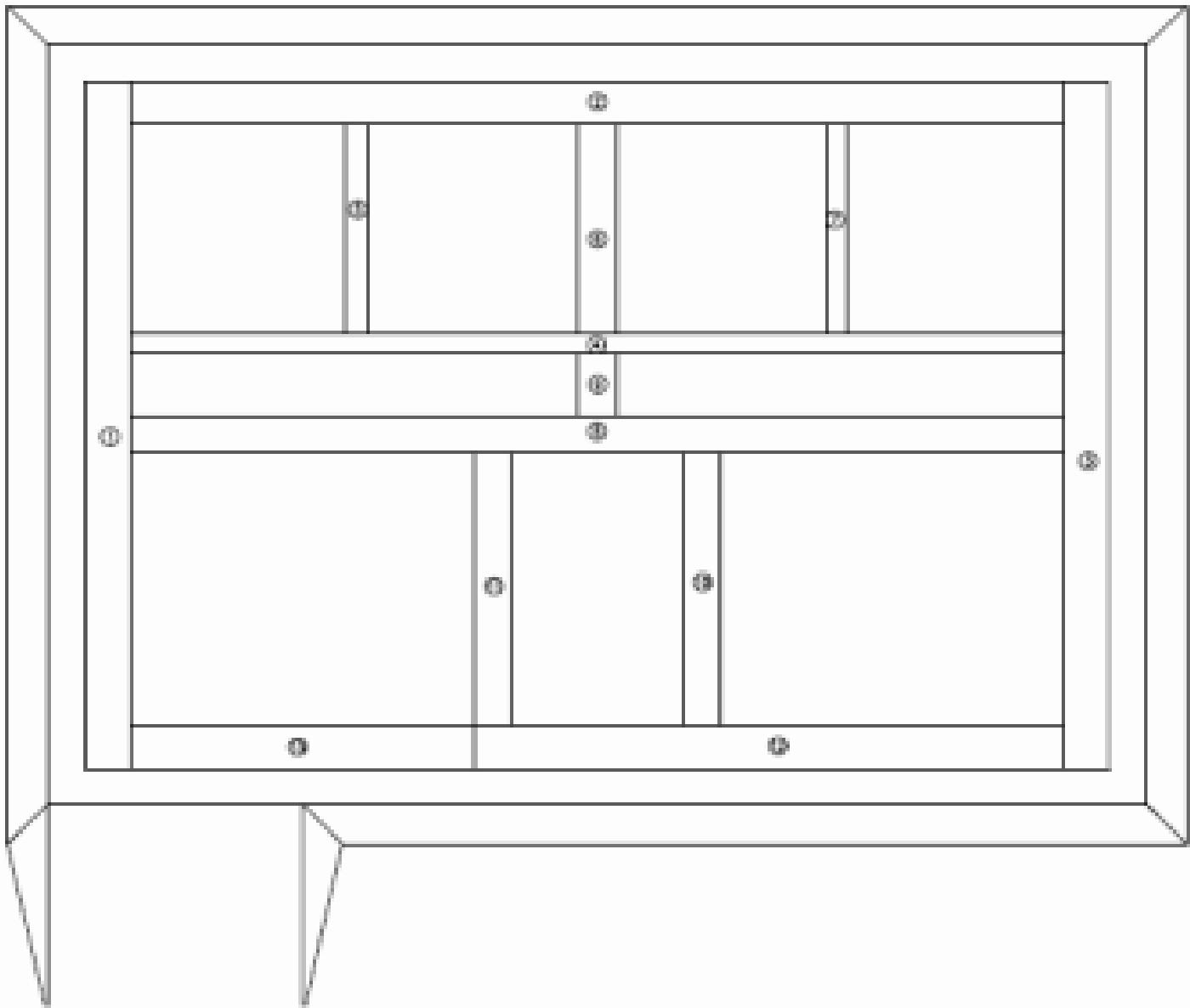

n for

S :