

1. Reakce

Lineární výpočet, Extrém : Uzel

Výběr : Vše

Zatěžovací stavy : ZS2

Podpora	Stav	d_x [m]	R_x [kN]	R_z [kN]	M_y [kNm]
Sn1/N1	ZS2		-0,81	5,55	0,00
Sb1/B1	ZS2	6,566	0,00	16,29	0,00

2. Reakce; R_z

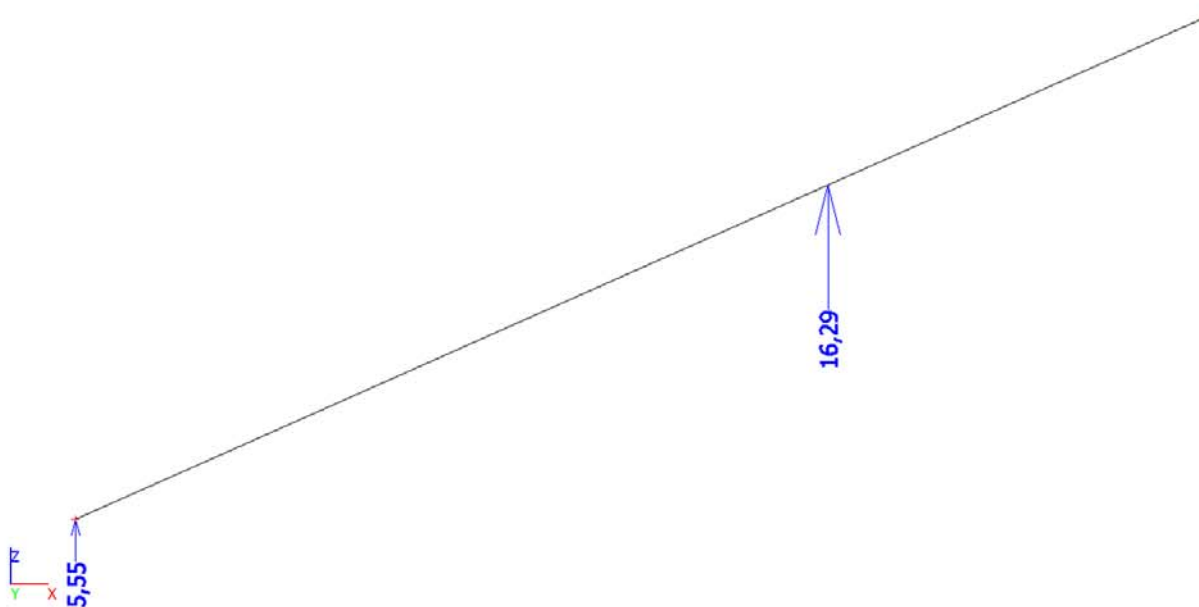

3. Reakce; R_x

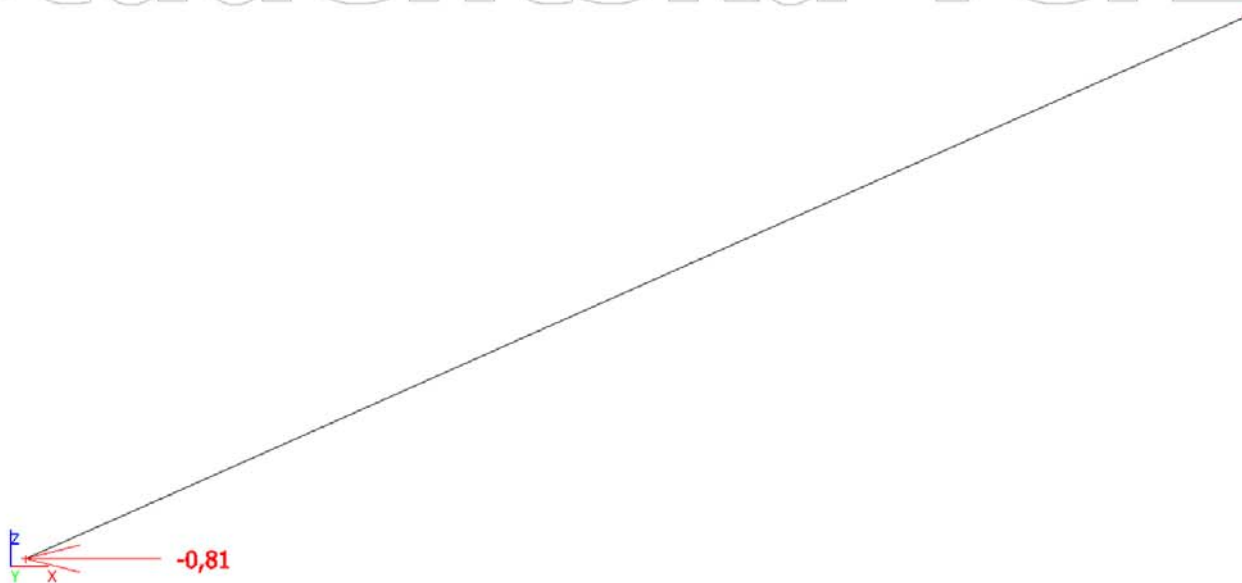

Studentská verze

4. Vnitřní síly na prutu; N

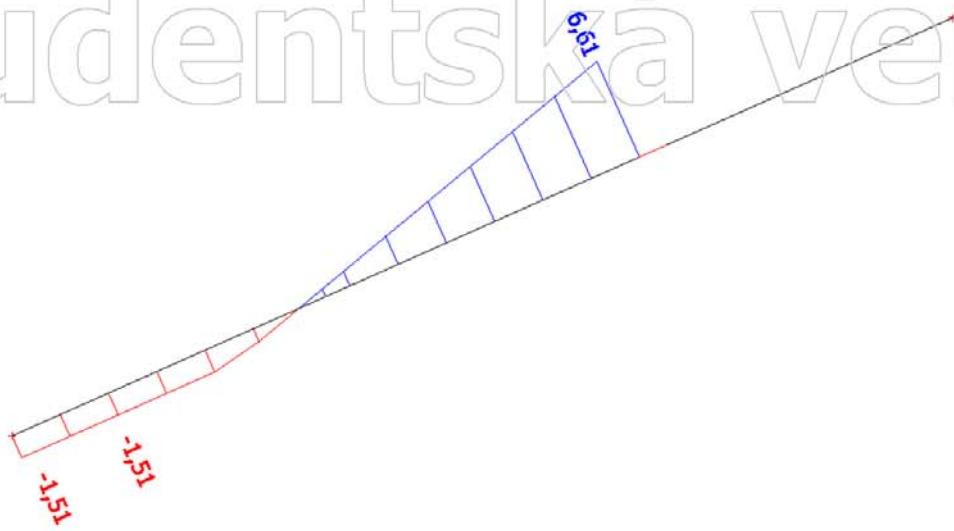

5. Vnitřní síly na prutu; Vz

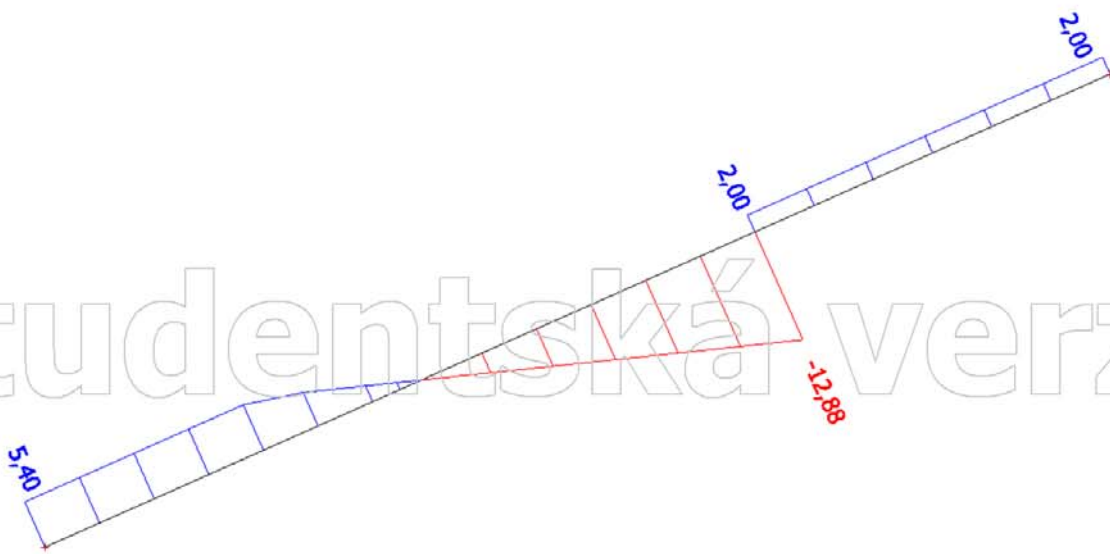

6. Vnitřní síly na prutu; My

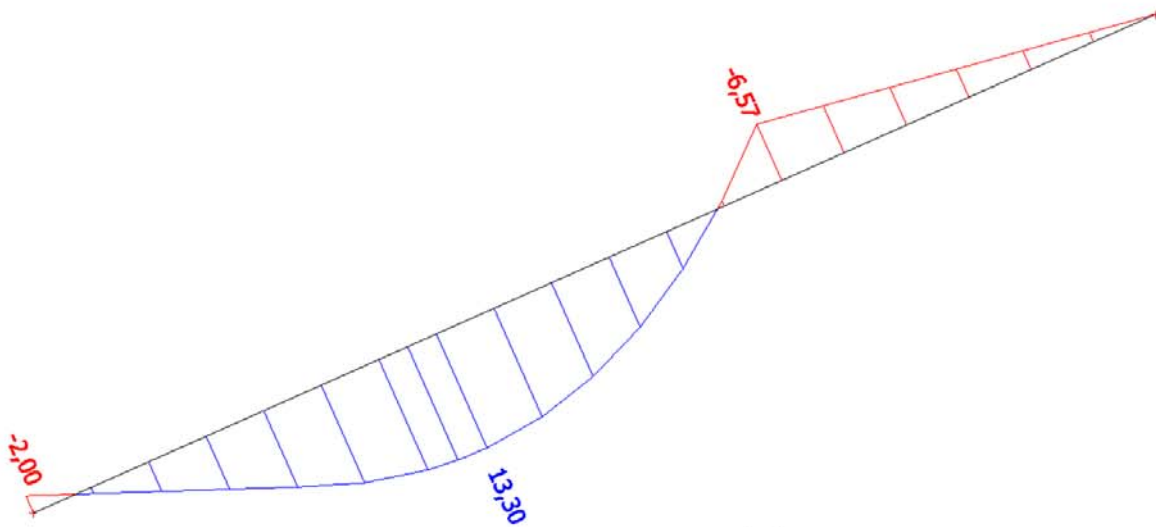

7. Vnitřní síly na prutu; N

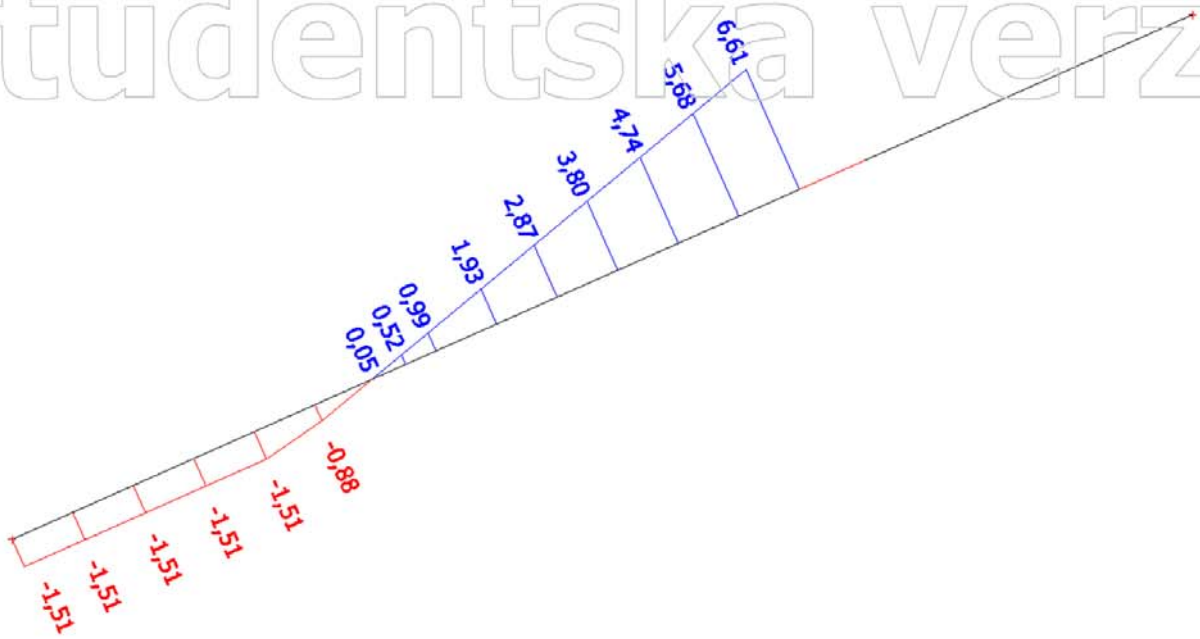

8. Vnitřní síly na prutu; M_y

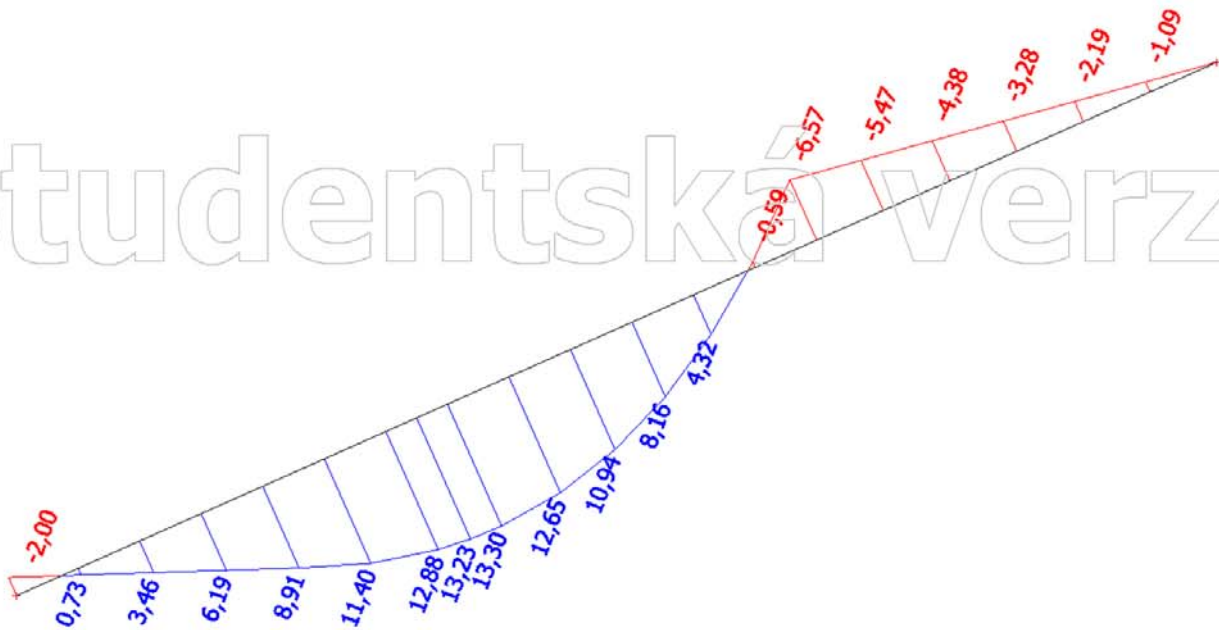

Studentská verze